

# BNS178/98II Series

Mixed Two-Color Injection Molding Machines

BNS178/98II系列混双色注塑机



[www.cn-bona.com](http://www.cn-bona.com)

**BN98-BN1380**



® 宁波博纳机械有限公司  
NINGBO BONA MACHINERY CO.,LTD.



# BNS178/98II Series

## 混双色注塑机

With major and minor two injection components, can inject synchronously or alternately through the professional computer controlling two screw bars, So as to get the plastic products with beautiful color; Also can manufacture the sandwich, Cloud marble and other plastic products, and the cost is reduced; can be widely used for PP, PE, PS and other raw materials in two color forming.

具有主、副两个注射部件，由专业电脑程序控制螺杆同时或交替注射，以达到制品色彩美丽如云的特殊效果。

也可以生产夹心、云彩大理石纹等制品、降低成本。

本机可广泛用于PP、PE、PS等原料的双色成型。

机型	SPECIFICATION	CN	BNS178/98II					
			A			B		
<b>注射装置 INJECTION UNIT</b>								
螺杆直径	Screw diameter	mm	40	45	48	34	37	40
螺杆长径比	Screw L/D ratio	L/D	23.2	20.3	22.7	22.8	21	22.7
理论注射容量	Shot volume(theoretical)	cm <sup>3</sup>	253	320	363	140	166	195
注射重量	Injection weight(ps)	g	230	292	329	129	150	177
注射压力	Injection pressure	MPa	245	194	170	254	215	184
注射速率	Injection rate	g/s	149	190	214	144	168	198
<b>锁模装置 CLAMPING UNIT</b>								
锁模力	Clamping force	kN	1780					
模板行程	Open stroke	mm	430					
模具模厚	Max.Mould height	mm	180-520					
拉杆内间距(宽X高)	Space between tie ba(WxH)	mm	465 x 465					
顶出行程	Ejector stroke	mm	140					
顶出力	Ejector stroke	kN	45					
<b>其它 OTHERS</b>								
系统压力	System Pressure	MPa	17.5					
驱动器功率	Motor power	kW	18.5/22					
电热功率	Heating power	kW	10					
外形尺寸(长X宽X高)	Machine dimension(LxWxH)	m	5.1 x 1.6 x 2.5					
机器重量	Machine weight	t	约5					

模板正面尺寸  
Platen Dimensions

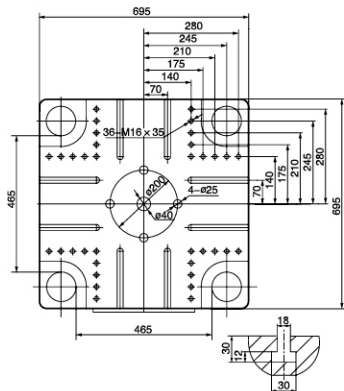

模板侧面尺寸  
Mould Space Dimensions

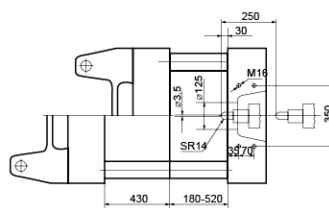

安装图  
Floor Plan Layout

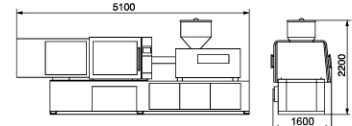

宁波博纳机械有限公司  
NINGBO BONA MACHINERY CO.,LTD.

[www.cn-bona.com](http://www.cn-bona.com)

<http://bona.gmc.globalmarket.com>

地址: 宁波市通途路小港工业园区创富路2号  
Add: Ningbo Avenue Buster Small Harbor  
Industrial Park Road No.2

Tel: (00) 86-574-88352626 13780013213  
Fax: (00) 86-574-87289035  
E-mail: bonajx@163.com

