

BN150R Series

Unmixed Two Color Injection Molding Machines

BN150R系列清双色注塑机



BN98-BN1380



® 宁波博纳机械有限公司
NINGBO BONA MACHINERY CO.,LTD.



BN150R Series

清双色注塑机

Rotary Disc Type Two-Color Injection Moulding Equipment:

- The turntable rotates 180 degrees to and fro to produce two-color distinct or different material products.
- High-precision servo valve control, turntable rotation more high-speed and stable
- Reasonable mechanism, precise positioning of turntable to ensure die life
- Mold manufacturing is simple, and products are more designed and functional.

转盘式双色注塑成型设备:

- 转盘往复180度旋转, 可产生双色分明或不同材料产品
- 高精度伺服阀控制, 转盘转动更加高速平稳
- 合理的机构, 转盘定位精准, 确保模具寿命
- 模具制造简易, 制品更具设计性和功能性

机型	SPECIFICATION	CN	BN150R			
			A	B	C	D
注射装置			INJECTION UNIT			
螺杆直径	Screw diameter	mm	26	28	30	32
螺杆长径比	Screw L/D ratio	L/D	23	21.4	20	18.7
理论注射容量	Shot volume(theoretical)	cm ³	80	93	107	121
注射重量	Injection weight(ps)	g	73	85	97	110
注射压力	Injection pressure	MPa	349	301	262	230
注射速率	Injection rate	g/s	82	96	109	124
料筒中心距	Barrel centre distance	mm	420			
锁模装置			CLAMPING UNIT			
锁模力	Clamping force	kN	1500			
模板行程	Open stroke	mm	320			
模具模厚	Max.Mould height	mm	120-460			
拉杆内间距(宽X高)	Space between tie ba(WxH)	mm	720x370			
模盘尺寸	Mould platen	mm	950x600			
转盘直径	Rotary table diameter	mm	780			
模具数量	Mold sets	set	2			
顶出行程	Ejector strokex	mm	85			
顶出力	Ejector stroke	kN	42			
其它			OTHERS			
油泵压力	Pump pressure	MPa	17.5			
驱动器功率	Motor power	kW	22+22			
电热功率	Heating power	kW	13			
外形尺寸(长X宽X高)	Machine dimension(LxWxH)	m	5.1x1.62x2.2			
机器重量	Machine weight	t	6.3			

模板正面尺寸

Platen Dimensions

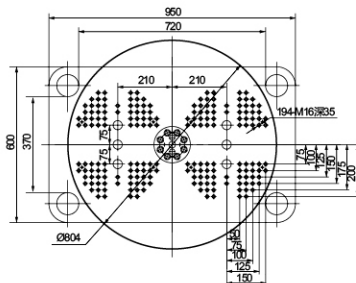

模板侧面尺寸

Mould Space Dimensions

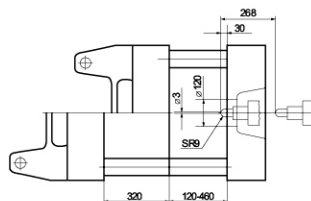

安装图

Floor Plan Layout

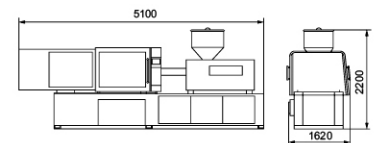

宁波博纳机械有限公司
NINGBO BONA MACHINERY CO.,LTD.

www.cn-bona.com

<http://bona.gmc.globalmarket.com>

地址: 宁波市通途路小港工业园区创富路2号
Add: Ningbo Avenue Buster Small Harbor
Industrial Park Road No.2

Tel: (00) 86-574-88352626 13780013213
Fax: (00) 86-574-87289035
E-mail: bonajx@163.com

